

TWEETER

19TAFD/G

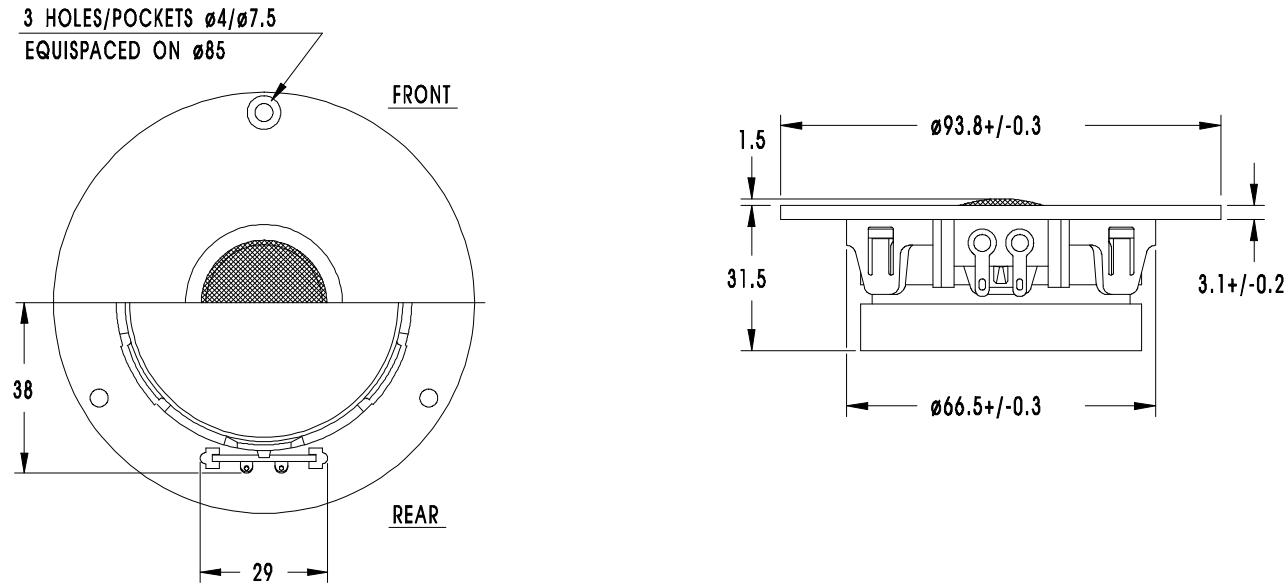

19mm High Fidelity dome tweeter with smooth, extended frequency response. The chassis is injection moulded in high grade glass fibre reinforced plastic. The diaphragm is made from a thin aluminium sheet and suspended by a specially designed soft surround which allows for a low fundamental frequency. A fine mesh grid protects the diaphragm and carries a phase plate which compensates for a slight axial roll of towards 20 kHz. A double magnet reduces stray fields around the magnet system and allows the unit to be used in close proximity to a CRT. The double magnet also gives a higher sensitivity. The voice coil is wound on an aluminium voice coil former with ventilating holes which eliminate problems connected with resonances in the internal cavities. The voice coil windings are immersed in magnetic fluid to increase short term power handling capacity, to reduce the compression at high power levels and to significantly reduce the Q factor.

NOTES

Response curve recorded in an anechoic chamber (Free-field, 4 pi radiation) with 0.5m microphone distance. The loudspeaker is mounted in a 0.6m by 0.8m baffle.

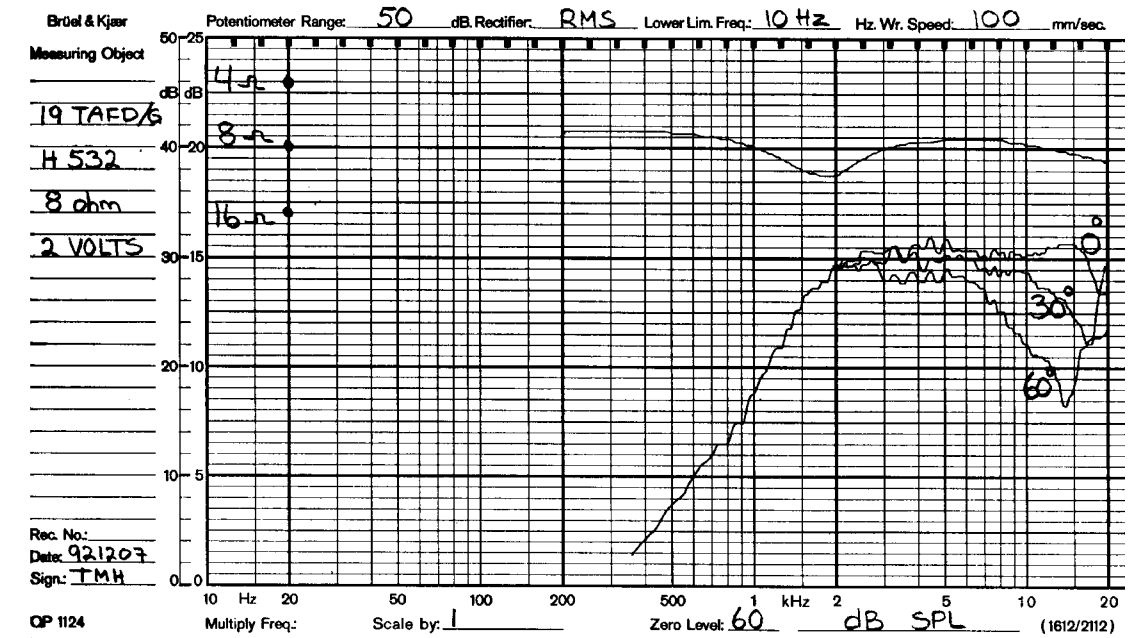

Cumulative spectral decay

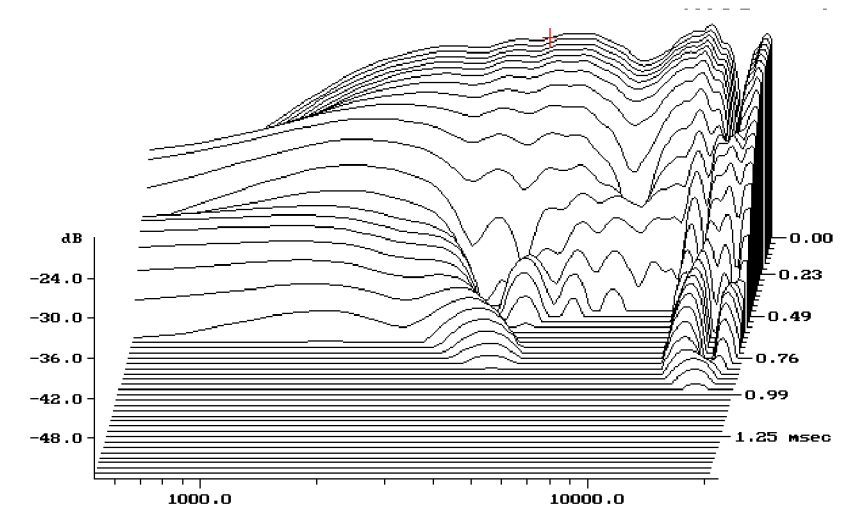

| | | | |
|-------------------------------------|---------------|------------------------------------|-----------|
| NOMINAL IMPEDANCE | 8 Ohms | VOICE COIL RESISTANCE | 6.2 Ohms |
| RECOMMENDED FREQUENCY RANGE | 4000-20000 Hz | VOICE COIL INDUCTANCE (EQUIVALENT) | 0.05 mH |
| SHORT TERM MAXIMUM POWER* | 220 W | VOICE COIL DIAMETER | 19.5 mm |
| LONG TERM MAXIMUM POWER* | 90 W | VOICE COIL HEIGHT | 1.5 mm |
| CHARACTERISTIC SENSITIVITY (1W, 1m) | 89 dB SPL | MOVING MASS | 0.23 g |
| OPERATING POWER (96 dB SPL, 1m) | 5.0 W | EFFECTIVE PISTON AREA | 4.0 sq.cm |
| | | LINEAR COIL TRAVEL (p-p) | 0.5 mm |
| AIR GAP HEIGHT | 2.0 mm | FREE AIR RESONANCE | 1700 Hz |
| MAGNETIC GAP FLUX DENSITY | 1.5 T | | |
| FORCE FACTOR | 2.8 N/A | | |
| MAGNET WEIGHT | 0.24 Kg | | |
| TOTAL WEIGHT | 0.40 Kg | | |

* IEC 268-5, VIA HIGH PASS BUTTERWORTH FILTER: 4000 Hz 12 dB/oct.